

7.3 Level thresholds

Where provision for level access is required, this shall be provided as shown in Figure 17A and Figure 17B.

7.3.1 Enclosed decks

Where provision for level access is required for an *enclosed deck*, this shall be provided in Figure 17A. The underlying *membrane deck* surface shall be made *weathertight* as described in Paragraph 8.5.

7.3.1.1 Removable surfaces

Raised removable surfaces of tiles or timber shall be provided over the underlying *weathertight enclosed deck* surface, as shown in Figure 17A. A minimum gap of 12 mm shall be provided against the wall or balustrade *cladding*.

7.3.1.2 Timber option

Timber decking shall be over 75 x 50 mm *framing* supported on blocks, with spacing in accordance with NZS 3604.

No fixings shall penetrate the underlying *deck membrane*.

COMMENT:

Access to the underlying *weathertight* surface, for cleaning and maintenance, must be provided.

Tiled boards or structural pavers sit on proprietary supports, that can be adjusted according to level changes in the underlying *deck* surface.

The pavers or tiled boards are spaced to allow free drainage and the ability to lift the top surface off when necessary.

The timber alternative allows access by fixing the timber decking with stainless steel screws, so they may be removed when necessary.

7.3.2 Ground floor level access

Where provision for level access is required, this may be provided as shown in Figure 17B, with exterior paving or decking that complies with the *access route* requirements of D1/AS1.

COMMENT:

The specific features of a *building* and its site can have a significant effect on the options available for providing level access at doors. These features include the provision of shelter, prevailing winds and ground levels. Where level access is required, it is highly recommended that the services of a designer experienced in this field be obtained.

7.3.2.1 Concrete slab

Where provision for level access is required from a concrete floor slab to exterior paving, this shall be as shown in Figure 17B with:

- a) A channel across the door opening, with:
 - i) the width to suit capacity in accordance with E1/AS1,
 - ii) a minimum depth of 150 mm,
 - iii) a maximum length of 2000 mm, and
 - iv) 1:200 minimum fall along length of channel towards a drainage outlet,
- b) Grating, in accordance with Table 20, over the channel, that:
 - i) is supported independently of the door frame,
 - ii) is removable to allow access for cleaning,
 - iii) is specifically designed to accommodate imposed loads,
 - iv) has gaps sized to prevent the wheels of wheel chairs or mobility aids entering or being trapped, and
 - v) has a continuous gap of 12 mm minimum from door frame and wall *cladding*, and
- c) Exterior paving that:
 - i) has a minimum fall of 1:40 away from the channel,

Amend 2
Jul 2005

COMMENT:

The grating support must be specifically detailed to suit the condition of the *building* and site.

- ii) together with the surrounding paving and ground levels, complies with drainage requirements of E1/AS1.

7.3.2.2 Timber floor

Where provision for level access is required from a timber floor to the exterior, this may be provided as shown in Figure 17B, with clearances in accordance with Paragraph 9.1.3.

Figure 17A: Level thresholds for enclosed decks
 Paragraphs 7.3, 7.3.1.1, 7.3.2 and 8.5.1 d), Figure 17B

NOTE: (1) For use for timber framed, above ground enclosed decks with membrane surfaces. Care must be taken to ensure that no fixings or sharp edges penetrate the weathertight membrane. Refer also to Paragraph 8.5.
 (2) Proprietary sill support system omitted for clarity.

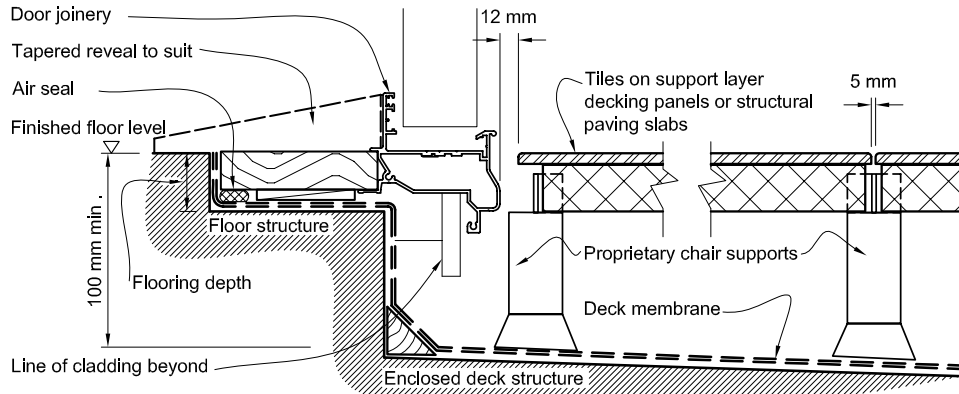

(a) TILE/PAVING

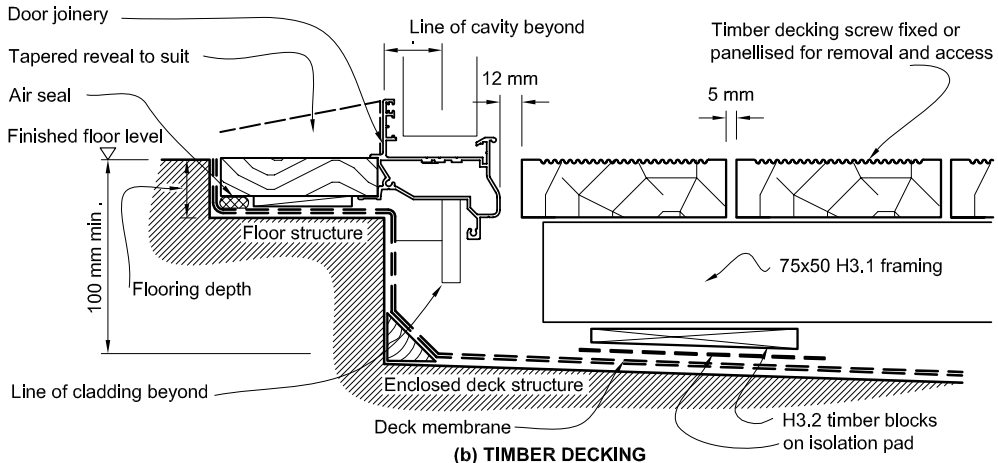

(b) TIMBER DECKING